

▲ WARNING
All repairs, adjustments and maintenance not described in the Operator's Manual must be performed by qualified service personnel.

| Ref. | Part No. | Description | Ref. | Part No. | Description |
|------|-----------|------------------------------|------|-----------|---|
| 1. | 530054183 | Ass'y. - Wire | 17. | 530071683 | Kit - Shield Ass'y. (Incl. 14, 15, 16, 18 & 19) |
| 2. | 530069888 | Kit - Throttle Hsg. (Right) | 18. | 530056401 | Wrench |
| 3. | 530095382 | Throttle Hsg. (Left) | 19. | 530015197 | Nut |
| 4. | 530069572 | Kit - Switch | 20. | 530095563 | Dust cup |
| 5. | 530038708 | Assist Handle | 21. | 530095846 | Cutting Head (Incl. 22-25) |
| 6. | 530015820 | Bolt | 22. | 530095776 | Hub Ass'y. |
| 7. | 530094742 | Clamp - Handle | 23. | 530053241 | Spring - Compression |
| 8. | 530016152 | Wingnut | 24. | 530401957 | Clip - Retainer |
| 9. | 530016273 | Screw - Throttle Hsg. | 25. | 530095845 | Spool w/Line |
| 10. | 530038682 | Trigger | | | |
| 11. | 530036744 | Assy - Throttle Cable | | | |
| 12. | --- | Kit - Drive Shaft Hsg. Ass'y | | | |
| | 530071313 | (45" Silver) | | | |
| | 530096232 | (51" Silver) | | | |
| 13. | --- | Drive Shaft - Flex | | | Not Shown |
| | 530095242 | (45") | | | |
| | 530095803 | (51") | | | |
| 14. | 530052286 | Line Limiter | | | Operator Manual |
| 15. | 530015886 | Screw - Line Limiter | | 530164222 | Aust |
| 16. | 530015820 | Bolt | | 530163997 | Euro |
| | | | | 530163998 | Decal - Shaft Warning |
| | | | | 530056462 | |

✓ = NEW PART NUMBER FOR THIS IPL ★ = REFER TO THE SERVICE REFERENCE INDICATED FOR MORE INFORMATION. (LOCATED AT END OF IPL)

⚠ WARNING
All repairs, adjustments and maintenance not described in the Operator's Manual must be performed by qualified service personnel.

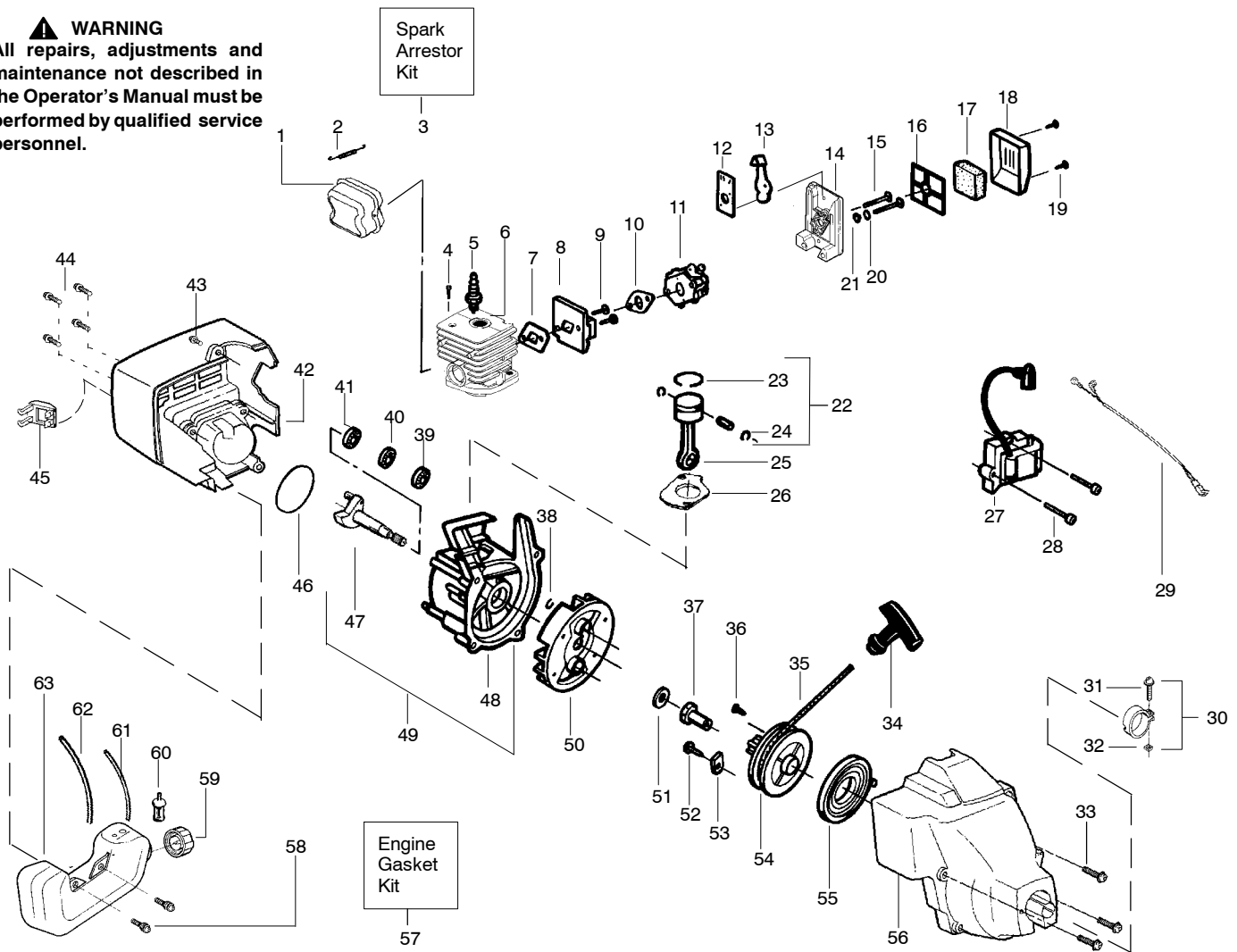

| Ref. | Part No. | Description | Ref. | Part No. | Description | Ref. | Part No. | Description |
|--|-----------|----------------------------------|------|-----------|---------------------------------------|------|-----------|---|
| 1. | 530071396 | Kit - Muffler (incl. 2) | 22. | 530071357 | Kit - Piston (Incl. 23, 24 & Pin) | 45. | 530054536 | Guard-Muffler |
| 2. | 530042088 | Spring-Muffler | 23. | 530055120 | Ring-Piston | 46. | 530071363 | O-Ring-C'case (kit) |
| 3. | 530071391 | Kit-Spark Arrestor | 24. | 530015162 | Retainer-Piston Pin | 47. | 530054753 | Assy-Crankshaft |
| 4. | 530015953 | Screw-Cylinder | 25. | 530069945 | Assy-Connecting Rod | 48. | 530071627 | Kit-Crankcase (Incl. 39-41) |
| 5. | Champion | Spark Plug (RCJ 6Y) | 26. | 530071363 | Gasket-Cylinder (kit) | 49. | 530071624 | Assy-C'case & C'shaft (Incl. 38,47,48) |
| 6. | 530071359 | Kit-Cylinder | 27. | 530039163 | Module-Ignition | 50. | 530069886 | Assy-Flywheel |
| 7. | 530071363 | Gasket-Cyl/Carb.(kit) | 28. | 530016357 | Screw | 51. | 530015828 | Washer-Flat |
| 8. | 530057634 | Adaptor-Carb. | 29. | 530049018 | Assy-Switch Wire | 52. | 530015775 | Screw |
| 9. | 530016014 | Screw | 30. | 530056365 | Assy-Nose Cone Clamp (Incls. 31 & 32) | 53. | 530027523 | Retainer |
| 10. | 530071363 | Gasket-Carb.(kit) | 31. | 530016381 | Screw-Nose Cone | 54. | 530069400 | Kit-Starter Pulley (Incl. 36) |
| 11. | 530071630 | Kit - Carburetor Ass'y (C1U-W7D) | 32. | 530016382 | Nut-Nose Cone | 55. | 530042085 | Spring-Starter |
| Repair kits are not available for this carb. - Please order complete assy. | | | 33. | 530015810 | Screw | 56. | 530071677 | Kit-Fan Hsg. Assy. |
| 12. | 530038747 | Plate-Choke Mounting | 34. | 530027569 | Handle-Starter | 57. | 530071363 | Kit-Engine Gasket (Incl. 7,10,26,46) |
| 13. | 530038686 | Shutter-Choke | 35. | 530069232 | Kit - Rope | 58. | 530016379 | Retainer-Fuel Tank |
| 14. | 530052431 | Box-Air | 36. | 530016392 | Screw | 59. | 530014347 | Assy-Fuel Cap w/ret. |
| 15. | 530016393 | Screw | 37. | 530038604 | Coupling-Drive | 60. | 530095646 | Assy-Fuel Pickup |
| 16. | 530036569 | Plate - Filter Support | 38. | 530015941 | Retain. Ring-C'shaft | 61. | 530069247 | Kit-Fuel Line (Small) |
| 17. | 530036575 | Foam-Air Filter | 39. | 530055728 | Bearing-Outer | 62. | 530069216 | Kit-Fuel Line (Large) |
| 18. | 530036568 | Cover-Air Filter | 40. | 530019264 | Seal-C'case | 63. | 530049296 | Assy-Fuel Tank (Incl. cap, fuel line, filter) |
| 19. | 530016349 | Screw | 41. | 530032125 | Bearing-Inner | | | |
| 20. | 530015852 | Spacer-Choke | 42. | 530057026 | Shroud-Rear | | | |
| 21. | 530015254 | Washer | 43. | 530015934 | Screw | | | |
| | | | 44. | 530015810 | Screw | | | |

✓ = NEW PART NUMBER FOR THIS IPL ★ = REFER TO THE SERVICE REFERENCE INDICATED FOR MORE INFORMATION. (LOCATED AT END OF IPL)